

FIRE TRAINING FACILITY #137

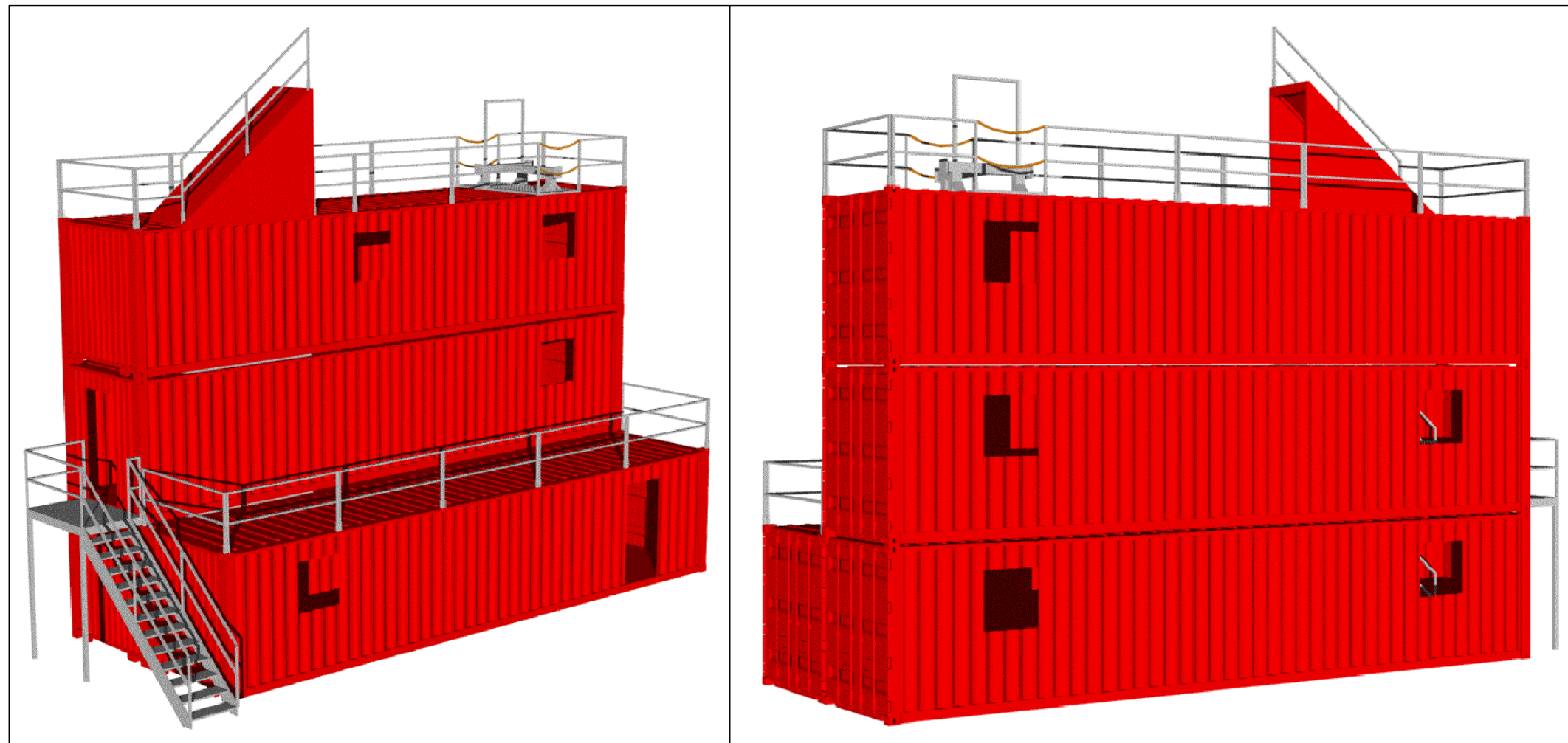

UNIT SPECIFICATIONS

- 4 40' CONTAINERS
- 3 TRAINING LEVELS
- 2 STANDARD DOORS
- 9 STANDARD WINDOWS
- 3 INTERIOR STAIRCASES
- 1 EXTERIOR STAIRCASE
w/ PLATFORM
- 1 15' PASS THRU
- 1 "T" BAR RAPPTEL STATION
w/ 6' EXTENSION & SAFETY
CHAINS
- 1 ROOFTOP STAIRCASE
ENCLOSURE
- 19 SAFETY RAILINGS

TRAINING AREA
TOTAL SQ. FT. = 1920 SQ.FT.

